



GENERAL NOTES	
1. ALL WORK SHALL BE IN ACCORDANCE WITH THE LATEST EDITIONS OF THE CALIFORNIA BUILDING CODE (CBC) AND THE CALIFORNIA MECHANICAL CODE (CMC).	
2. ALL MATERIALS SHALL BE OF THE QUALITY AND GRADE SPECIFIED HEREIN.	
3. ALL WORK SHALL BE SUBJECT TO INSPECTION AND APPROVAL BY THE LOCAL BUILDING DEPARTMENT.	
4. THE CONTRACTOR SHALL BE RESPONSIBLE FOR OBTAINING ALL NECESSARY PERMITS.	
5. ALL DIMENSIONS SHALL BE AS SHOWN UNLESS OTHERWISE NOTED.	
6. ALL WORK SHALL BE COMPLETED WITHIN THE SPECIFIED TIME FRAME.	
7. THE CONTRACTOR SHALL MAINTAIN ACCESS TO ALL ADJACENT PROPERTIES AT ALL TIMES.	
8. ALL UTILITIES SHALL BE PROTECTED AND MARKED PRIOR TO EXCAVATION.	
9. THE CONTRACTOR SHALL BE RESPONSIBLE FOR PROTECTING ALL EXISTING UTILITIES.	
10. ALL WORK SHALL BE COMPLETED IN ACCORDANCE WITH THE SPECIFICATIONS AND NOTES.	

SPECIFICATIONS	
1. ALL WORK SHALL BE IN ACCORDANCE WITH THE LATEST EDITIONS OF THE CALIFORNIA BUILDING CODE (CBC) AND THE CALIFORNIA MECHANICAL CODE (CMC).	
2. ALL MATERIALS SHALL BE OF THE QUALITY AND GRADE SPECIFIED HEREIN.	
3. ALL WORK SHALL BE SUBJECT TO INSPECTION AND APPROVAL BY THE LOCAL BUILDING DEPARTMENT.	
4. THE CONTRACTOR SHALL BE RESPONSIBLE FOR OBTAINING ALL NECESSARY PERMITS.	
5. ALL DIMENSIONS SHALL BE AS SHOWN UNLESS OTHERWISE NOTED.	
6. ALL WORK SHALL BE COMPLETED WITHIN THE SPECIFIED TIME FRAME.	
7. THE CONTRACTOR SHALL MAINTAIN ACCESS TO ALL ADJACENT PROPERTIES AT ALL TIMES.	
8. ALL UTILITIES SHALL BE PROTECTED AND MARKED PRIOR TO EXCAVATION.	
9. THE CONTRACTOR SHALL BE RESPONSIBLE FOR PROTECTING ALL EXISTING UTILITIES.	
10. ALL WORK SHALL BE COMPLETED IN ACCORDANCE WITH THE SPECIFICATIONS AND NOTES.	

BILL OF MATERIALS	
1. ALL WORK SHALL BE IN ACCORDANCE WITH THE LATEST EDITIONS OF THE CALIFORNIA BUILDING CODE (CBC) AND THE CALIFORNIA MECHANICAL CODE (CMC).	
2. ALL MATERIALS SHALL BE OF THE QUALITY AND GRADE SPECIFIED HEREIN.	
3. ALL WORK SHALL BE SUBJECT TO INSPECTION AND APPROVAL BY THE LOCAL BUILDING DEPARTMENT.	
4. THE CONTRACTOR SHALL BE RESPONSIBLE FOR OBTAINING ALL NECESSARY PERMITS.	
5. ALL DIMENSIONS SHALL BE AS SHOWN UNLESS OTHERWISE NOTED.	
6. ALL WORK SHALL BE COMPLETED WITHIN THE SPECIFIED TIME FRAME.	
7. THE CONTRACTOR SHALL MAINTAIN ACCESS TO ALL ADJACENT PROPERTIES AT ALL TIMES.	
8. ALL UTILITIES SHALL BE PROTECTED AND MARKED PRIOR TO EXCAVATION.	
9. THE CONTRACTOR SHALL BE RESPONSIBLE FOR PROTECTING ALL EXISTING UTILITIES.	
10. ALL WORK SHALL BE COMPLETED IN ACCORDANCE WITH THE SPECIFICATIONS AND NOTES.	

GENERAL CONTRACTOR	
1. ALL WORK SHALL BE IN ACCORDANCE WITH THE LATEST EDITIONS OF THE CALIFORNIA BUILDING CODE (CBC) AND THE CALIFORNIA MECHANICAL CODE (CMC).	
2. ALL MATERIALS SHALL BE OF THE QUALITY AND GRADE SPECIFIED HEREIN.	
3. ALL WORK SHALL BE SUBJECT TO INSPECTION AND APPROVAL BY THE LOCAL BUILDING DEPARTMENT.	
4. THE CONTRACTOR SHALL BE RESPONSIBLE FOR OBTAINING ALL NECESSARY PERMITS.	
5. ALL DIMENSIONS SHALL BE AS SHOWN UNLESS OTHERWISE NOTED.	
6. ALL WORK SHALL BE COMPLETED WITHIN THE SPECIFIED TIME FRAME.	
7. THE CONTRACTOR SHALL MAINTAIN ACCESS TO ALL ADJACENT PROPERTIES AT ALL TIMES.	
8. ALL UTILITIES SHALL BE PROTECTED AND MARKED PRIOR TO EXCAVATION.	
9. THE CONTRACTOR SHALL BE RESPONSIBLE FOR PROTECTING ALL EXISTING UTILITIES.	
10. ALL WORK SHALL BE COMPLETED IN ACCORDANCE WITH THE SPECIFICATIONS AND NOTES.	

MECHANICAL CONTRACTOR	
1. ALL WORK SHALL BE IN ACCORDANCE WITH THE LATEST EDITIONS OF THE CALIFORNIA BUILDING CODE (CBC) AND THE CALIFORNIA MECHANICAL CODE (CMC).	
2. ALL MATERIALS SHALL BE OF THE QUALITY AND GRADE SPECIFIED HEREIN.	
3. ALL WORK SHALL BE SUBJECT TO INSPECTION AND APPROVAL BY THE LOCAL BUILDING DEPARTMENT.	
4. THE CONTRACTOR SHALL BE RESPONSIBLE FOR OBTAINING ALL NECESSARY PERMITS.	
5. ALL DIMENSIONS SHALL BE AS SHOWN UNLESS OTHERWISE NOTED.	
6. ALL WORK SHALL BE COMPLETED WITHIN THE SPECIFIED TIME FRAME.	
7. THE CONTRACTOR SHALL MAINTAIN ACCESS TO ALL ADJACENT PROPERTIES AT ALL TIMES.	
8. ALL UTILITIES SHALL BE PROTECTED AND MARKED PRIOR TO EXCAVATION.	
9. THE CONTRACTOR SHALL BE RESPONSIBLE FOR PROTECTING ALL EXISTING UTILITIES.	
10. ALL WORK SHALL BE COMPLETED IN ACCORDANCE WITH THE SPECIFICATIONS AND NOTES.	

OWNER	
1. ALL WORK SHALL BE IN ACCORDANCE WITH THE LATEST EDITIONS OF THE CALIFORNIA BUILDING CODE (CBC) AND THE CALIFORNIA MECHANICAL CODE (CMC).	
2. ALL MATERIALS SHALL BE OF THE QUALITY AND GRADE SPECIFIED HEREIN.	
3. ALL WORK SHALL BE SUBJECT TO INSPECTION AND APPROVAL BY THE LOCAL BUILDING DEPARTMENT.	
4. THE CONTRACTOR SHALL BE RESPONSIBLE FOR OBTAINING ALL NECESSARY PERMITS.	
5. ALL DIMENSIONS SHALL BE AS SHOWN UNLESS OTHERWISE NOTED.	
6. ALL WORK SHALL BE COMPLETED WITHIN THE SPECIFIED TIME FRAME.	
7. THE CONTRACTOR SHALL MAINTAIN ACCESS TO ALL ADJACENT PROPERTIES AT ALL TIMES.	
8. ALL UTILITIES SHALL BE PROTECTED AND MARKED PRIOR TO EXCAVATION.	
9. THE CONTRACTOR SHALL BE RESPONSIBLE FOR PROTECTING ALL EXISTING UTILITIES.	
10. ALL WORK SHALL BE COMPLETED IN ACCORDANCE WITH THE SPECIFICATIONS AND NOTES.	

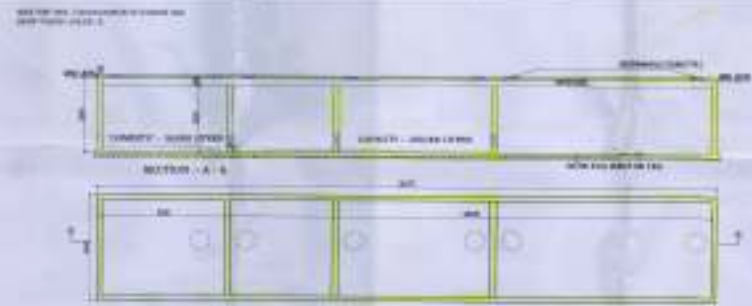
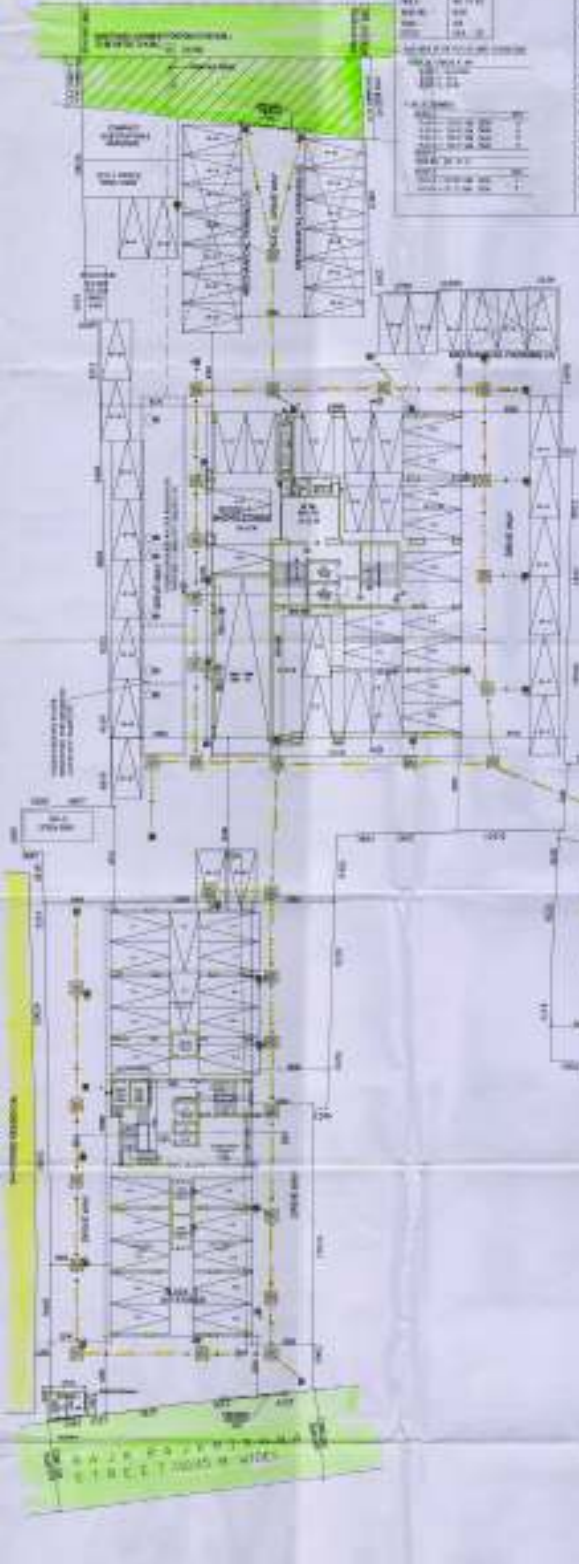

PLAN OF DECK (GROUND WATER RESISTION) FOR THE EXISTING CONCRETE - 30,000 LB/SQ YD AND FOR DOMESTIC - 30,000 LB/SQ YD. SCALE: 1/8"

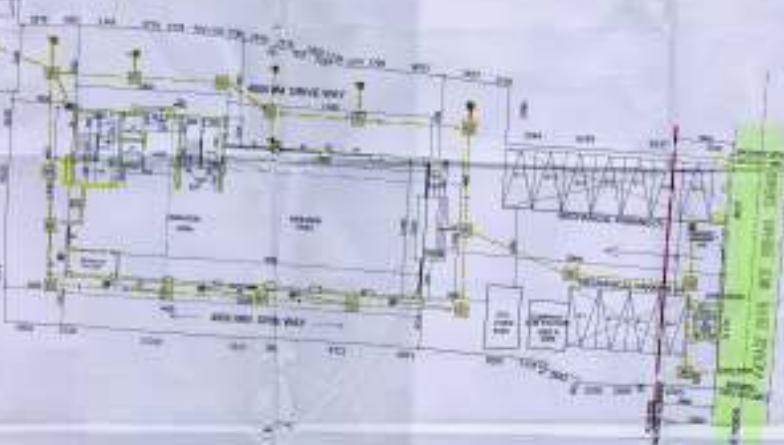

GROUND FLOOR PLAN SCALE: 1/8"

2ND FLOOR SCALE: 1/8"

DESIGNED BY: [Signature]

DATE: 12/15/2010

PROJECT NO: 10101

OWNER: [Name]

LOCATION: [Address]

SCALE: 1/8"

REVISIONS:

1. [Description]

2. [Description]

3. [Description]

4. [Description]

5. [Description]

6. [Description]

7. [Description]

8. [Description]

9. [Description]

10. [Description]

5

41

United States
Department of Justice
Federal Bureau of Investigation

PARTY'S COPY

Report by SA [Name] on [Date]

TO: SAC, [City]
FROM: SA, [City]
SUBJECT: [Subject Name]
[Additional details]

SEARCHED
SERIALIZED
INDEXED
FILED
FBI - [City]